

Hypertherm®

HySpeed® HT2000®

Consumables

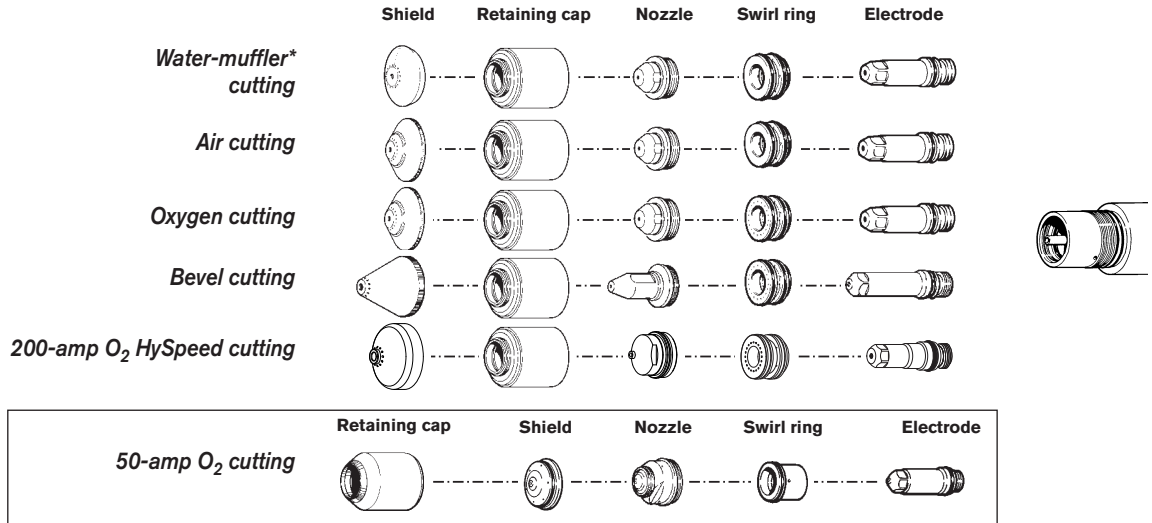

APPLICATION	PLASMA GAS	CONSUMABLE DESCRIPTION	PART NUMBER						
			200 AMP HySpeed	200 AMP BEVEL	200 AMPS	100 AMPS	50 AMPS	40 AMPS	
CUTTING	Oxygen	Electrode	220235	120258	120667	120547	120178	-----	
		Electrode SilverPlus	-----	-----	220084	-----	-----	-----	
		Swirl ring	220236	120833	120833	020613	120179	-----	
		Nozzle	220237	120259	020605	020690	120182	-----	
		Retaining cap*	220238	020423	020423	020423	120185	-----	
		Shield	220239	120260	020424	020424	120186	-----	
		(Water muffler**)	Shield	220295	-----	020566	020566	-----	
		Air	Electrode	-----	-----	120667	120547	-----	120667
			Swirl ring	-----	-----	020679	020607	-----	020613
			Nozzle	-----	-----	020608	020611	-----	020689
	Retaining cap*		-----	-----	020423	020423	-----	020423	
	(Water muffler**)	Shield	-----	-----	020424	020448	-----	020688	
		Shield	-----	-----	020566	020618	-----	-----	
	Argon/Hydrogen	Electrode	-----	-----	020415	020415	-----	-----	
		Swirl ring	-----	-----	020607	020607	-----	-----	
		Nozzle	-----	-----	020608	020611	-----	-----	
		Retaining cap*	-----	-----	020423	020423	-----	-----	
	Nitrogen	Electrode	-----	-----	020415	-----	-----	-----	
		Swirl ring	-----	-----	020607	-----	-----	-----	
		Nozzle	-----	-----	020608	-----	-----	-----	
Retaining cap*		-----	-----	020423	-----	-----	-----		
(Water muffler*)	Shield	-----	-----	020424	-----	-----	-----		
	Shield	-----	-----	020566	-----	-----	-----		
Cutting with counterclockwise gas swirl (substitute designated parts)	Oxygen	Swirl ring	220244	120834	120834	120252	-----		
	Retaining cap*	-----	220241	020955	020955	-----	-----		
	Air	Swirl ring	-----	-----	-----	020956	-----		
	Retaining cap*	-----	-----	-----	020955	-----	-----		
Argon/Hydrogen	Swirl ring	-----	-----	020956	020956	-----	-----		
	Retaining cap*	-----	-----	020955	020955	-----	-----		
Nitrogen	Swirl ring	-----	-----	020956	-----	-----	-----		
	Retaining cap*	-----	-----	020955	-----	-----	-----		
GOUGING	Air	Electrode	-----	-----	120667	-----	-----		
		Swirl ring	-----	-----	020607	-----	-----		
		Nozzle	-----	-----	020615	-----	-----		
		Retaining cap	-----	-----	020423	-----	-----		
		Shield	-----	-----	020485	-----	-----		
	Argon/Hydrogen	Electrode	-----	-----	020415	-----	-----		
		Swirl ring	-----	-----	020607	-----	-----		
		Nozzle	-----	-----	020615	-----	-----		
		Retaining cap	-----	-----	020423	-----	-----		
		Shield	-----	-----	020485	-----	-----		

* If using the Command THC or other ohmic sensing device, use retaining caps with an IHS tab: for standard cutting 120837 clockwise; 120838 counter clockwise for all cutting currents except 50 A; 120185 for 50 A only. For HySpeed use 220242 clockwise; 220243 counter clockwise.

** Water muffler cannot be used with 2" 120356 stainless steel torch.

HySpeed HT2000 torch assembly

- 128381 Standard body – 2" sleeve;
- 128367 Stainless steel body – 2" sleeve
- 128141 Standard body, optional – 1 3/4" sleeve

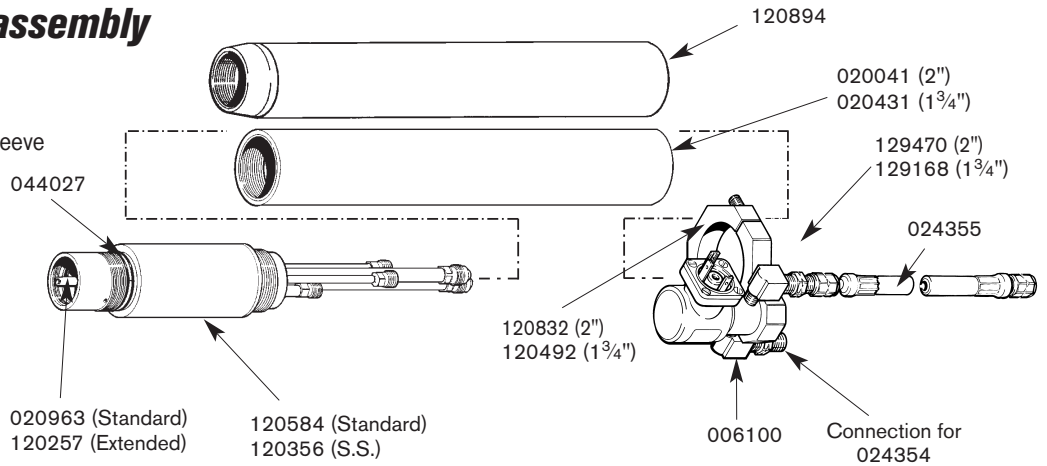

STANDARD BODY PART NO.	DESCRIPTION	STAINLESS STEEL BODY PART NO.
128381	HT2000 torch assembly with valve	128367
120584	MAX200/HT2000 machine torch main body	120356
020963	Water tube, electrode cooling, standard	020963
120257	Water tube, electrode cooling, extended	120257
044027	O-ring: Buna 70 Duro 1.301 x .070	044027
129470/129168*	HT2000 off-valve assembly	129470
006100	Solenoid valve, 120# 1/8" FPT	006100
024355	Hose, off-valve assembly to torch main body, 1'	024355
120894/020431	Torch mounting sleeve	020041
020407	Adapter: 1 3/4" – 2" torch mounting sleeve	Not needed
120832/120492**	Valve mounting bracket	120832
123185	Torch off-valve cable (not shown)	123185
024354	Hose, motor-valve box to off-valve assembly, 10.25'	024354

*129168 Off-valve assembly is required with the optional 020431 1 3/4" mounting sleeve.

** 120492 Valve mounting bracket is required with the 020431 mounting sleeve.

HySpeed HT2000LHF torch assembly

- 128255 Standard body – 2" sleeve
- 128369 Stainless steel body – 2" sleeve

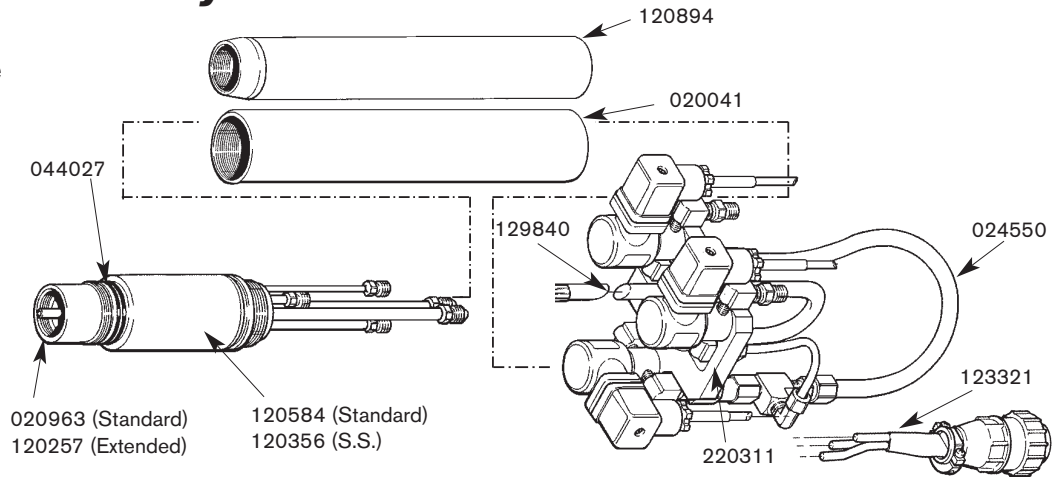

STANDARD BODY PART NO.	DESCRIPTION	STAINLESS STEEL BODY PART NO.
128255	HT2000 torch assembly with valve	128369
120584	MAX200/HT2000 machine torch main body	120356
120894	Torch mounting sleeve: 2"	020041
020963	Water tube, electrode cooling, standard	020963
120257	Water tube, electrode cooling, extended	120257
044027	O-ring: Buna 70 Duro 1.301 x .070	044027
024550	Hose, off-valve assembly to torch main body	024550
123321	Cable: HT2000LHF torch off-valve 24"	123321
129290	Off-valve sub assembly	129840
220311	Bracket: HT2000LHF off-valve	220311